

7RWWW Automatic Tube Weld Reducing Tee ASME BPE

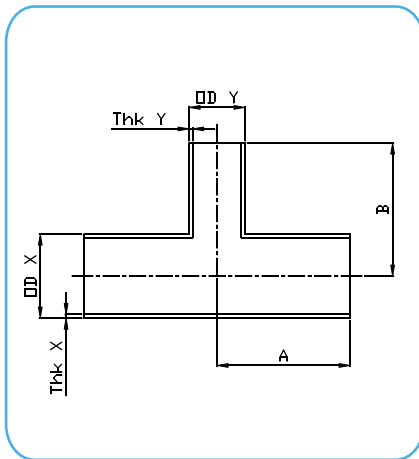

Technical Information:

Connections: Automatic Tube Weld according to ASME BPE (latest ed.)

Material: AISI 316L – 1.4404

Internal Surface Finish: SF1 Ra ≤ 0.5 μm → code **13** e.g.: 7RWWW-...-**13A**

Optional: SF4 Ra ≤ 0.38 μm Electropolish → code **43** e.g.: 7RWWW-...-**43A**

7RWWW-REDUCING TEE BW x BW ASME BPE DT-4.1.2-6

| CODE | Size inch | ODX x ThkX (mm) | ODY x ThkY (mm) | A (mm) | B (mm) |
|--------------------|--------------|--------------------|--------------------|-----------|-----------|
| 7RWWW-A075X050-13A | ¾" x ½" | 19.05 x 1.65 | 12.7 x 1.65 | 50.8 | 50.8 |
| 7RWWW-A100X050-13A | 1" x ½" | 25.4 x 1.65 | 12.7 x 1.65 | 54.0 | 54.0 |
| 7RWWW-A100X075-13A | 1" x ¾" | 25.4 x 1.65 | 19.05 x 1.65 | 54.0 | 54.0 |
| 7RWWW-A150X050-13A | 1 ½" x ½" | 38.1 x 1.65 | 12.7 x 1.65 | 60.3 | 60.3 |
| 7RWWW-A150X075-13A | 1 ½" x ¾" | 38.1 x 1.65 | 19.05 x 1.65 | 60.3 | 60.3 |
| 7RWWW-A150X100-13A | 1 ½" x 1" | 38.1 x 1.65 | 25.4 x 1.65 | 60.3 | 60.3 |
| 7RWWW-A200X050-13A | 2" x ½" | 50.8 x 1.65 | 12.7 x 1.65 | 73.0 | 66.7 |
| 7RWWW-A200X075-13A | 2" x ¾" | 50.8 x 1.65 | 19.05 x 1.65 | 73.0 | 66.7 |
| 7RWWW-A200X100-13A | 2" x 1" | 50.8 x 1.65 | 25.4 x 1.65 | 73.0 | 66.7 |
| 7RWWW-A200X150-13A | 2" x 1 ½" | 50.8 x 1.65 | 38.1 x 1.65 | 73.0 | 66.7 |
| 7RWWW-A250X050-13A | 2 ½" x ½" | 63.5 x 1.65 | 12.7 x 1.65 | 79.4 | 73.0 |
| 7RWWW-A250X075-13A | 2 ½" x ¾" | 63.5 x 1.65 | 19.05 x 1.65 | 79.4 | 73.0 |
| 7RWWW-A250X100-13A | 2 ½" x 1" | 63.5 x 1.65 | 25.4 x 1.65 | 79.4 | 73.0 |
| 7RWWW-A250X150-13A | 2 ½" x 1 ½" | 63.5 x 1.65 | 38.1 x 1.65 | 79.4 | 73.0 |
| 7RWWW-A250X200-13A | 2 ½" x 2" | 63.5 x 1.65 | 50.8 x 1.65 | 79.4 | 73.0 |
| 7RWWW-A300X050-13A | 3" x ½" | 76.2 x 1.65 | 12.7 x 1.65 | 85.7 | 79.4 |
| 7RWWW-A300X075-13A | 3" x ¾" | 76.2 x 1.65 | 19.05 x 1.65 | 85.7 | 79.4 |
| 7RWWW-A300X100-13A | 3" x 1" | 76.2 x 1.65 | 25.4 x 1.65 | 85.7 | 79.4 |
| 7RWWW-A300X150-13A | 3" x 1 ½" | 76.2 x 1.65 | 38.1 x 1.65 | 85.7 | 79.4 |
| 7RWWW-A300X200-13A | 3" x 2" | 76.2 x 1.65 | 50.8 x 1.65 | 85.7 | 79.4 |
| 7RWWW-A300X250-13A | 3" x 2 ½" | 76.2 x 1.65 | 63.5 x 1.65 | 85.7 | 79.4 |
| 7RWWW-A400X050-13A | 4" x ½" | 101.6 x 2.10 | 12.7 x 1.65 | 104.8 | 92.1 |
| 7RWWW-A400X075-13A | 4" x ¾" | 101.6 x 2.10 | 19.05 x 1.65 | 104.8 | 92.1 |
| 7RWWW-A400X100-13A | 4" x 1" | 101.6 x 2.10 | 25.4 x 1.65 | 104.8 | 92.1 |
| 7RWWW-A400X150-13A | 4" x 1 ½" | 101.6 x 2.10 | 38.1 x 1.65 | 104.8 | 92.1 |
| 7RWWW-A400X200-13A | 4" x 2" | 101.6 x 2.10 | 50.8 x 1.65 | 104.8 | 98.4 |
| 7RWWW-A400X250-13A | 4" x 2 ½" | 101.6 x 2.10 | 63.5 x 1.65 | 104.8 | 98.4 |
| 7RWWW-A400X300-13A | 4" x 3" | 101.6 x 2.10 | 76.2 x 1.65 | 104.8 | 98.4 |

DATASHEETS



Last updates can be found on our website - www.aerreinox.it
In the interests of development of the product, we reserve the right to change the specifications without prior notice